

# Order form:

## Construction and the Built Environment Level 2 Diploma Student Handbook

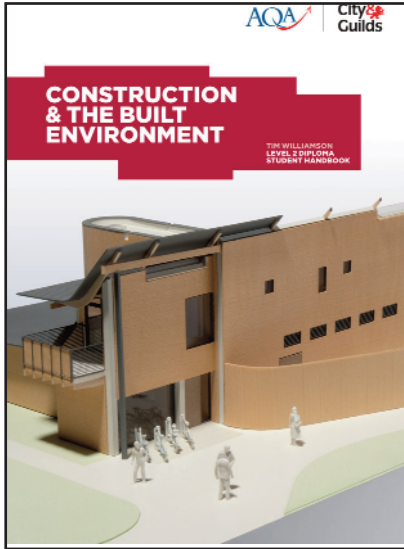

- Explains what students need to do unit by unit in an inspiring and innovative way.
- PLTS forms enable students to record their progress and saves teachers developing their own.
- Aids understanding and enjoyment of the course.
- Written by experts in a language level 2 learners can relate to.

### Contact details

Centre name: \_\_\_\_\_ Centre number (if applicable): \_\_\_\_\_

Price: £12.00 per copy plus postage & packaging \_\_\_\_\_  
 (Add £5 if the order total is under £30, £10 if the order is over £30)

Address: \_\_\_\_\_

\_\_\_\_\_  
 Postcode: \_\_\_\_\_

Contact name: \_\_\_\_\_ Job title: \_\_\_\_\_

Email address: \_\_\_\_\_

Telephone: \_\_\_\_\_

Number of copies required: \_\_\_\_\_ Total order value inc.post and packaging: \_\_\_\_\_

Signed: \_\_\_\_\_ Dated: \_\_\_\_\_

### Payment details

#### To pay by cheque:

Please complete this form and return with your cheque made payable to 'City & Guilds' for the total order value (inc p&p) to: Teaching & Learning Materials, Learning Solutions, City & Guilds, 1 Giltspur Street, London, EC1A 9DD.

#### To order online:

Visit [www.walled-garden.com](http://www.walled-garden.com) which is a secure website for centres registered with City & Guilds.

#### To pay by credit card please contact:

[learningmaterials@cityandguilds.com](mailto:learningmaterials@cityandguilds.com), or phone **020 7294 4113**.